

HAVING TROUBLE W/ YOUR SOUND SYSTEM?

CONDITION

No Sound (Power LED Not Lit)

POSSIBLE CAUSE

- turn POWER switch on
- plug in power cord
- check for blown fuse
- check for output from source
- make sure all cables are completely plugged in
- increase volume control
- check input cable connection
- lower input signal level
- use shielded input cable
- set balanced input to mic-level
- shorted speaker cable

No Sound (Power LED Lights)

Distorted Sound

Excessive Hum / Noise

Mic Volume Too Low

Blows Fuse w/ Auxiliary Speaker

Anchor Audio Customer Service

888/444-6077 310/784-2300

www.anchoraudio.com



AN-1000X

Portable Sound System

OWNER'S MANUAL



AN-1000X TECHNICAL SPECIFICATIONS

Rated Power Output	50 watts continuous @ 4 ohm	<i>Inputs</i>	
Max SPL @ Rated Power	103 dB @ 1 meter	Balanced	female XLR, switchable phantom power, 15 volts DC @ 6.8 k ohm
Frequency Response	65 Hz - 20 kHz ± 3 dB	Mic-Level Setting	Lo-Z
Speaker Type	4.5" woofer w/ shielded magnet, 10mm dome tweeter	Line-Level Setting	Bridging (10 k ohm)
AC Power Reqs.	110 - 125Vac, 50/60 Hz, 90W Max	Line	Hi-Z, unbalanced, 1/4"-phone & RCA
Export Model	208 - 240Vac, 50/60 Hz, 90W Max	<i>Outputs</i>	
Dimensions (HWD)	5.25 x 8.4 x 9" / 13 x 21 x 23 cm	Line (post fader)	Lo-Z, buffered, RCA
Weight	9.5 pounds / 4.3 Kg	Speaker	8 ohm, unswitched, 1/4"-phone
<i>Tone Controls</i>		<i>Sensitivity For Rated Output</i>	
Bass	+8 - 12 dB @ 100 Hz	Line	balanced -18 dBv (125 mVrms)
Treble	+10 - 12 dB @ 10 kHz	Microphone	balanced -56 dBv (1.5 mVrms)
		Line	-18 dBv (125 mVrms)

(Specifications subject to change without notice)



Anchor Audio, Inc.

Portable Sound Systems • Torrance, California

CONTENTS

GETTING STARTED	2
FEEDBACK.....	3
BASIC SYSTEM OPERATION.....	4
BALANCED INPUT JACK.....	4
AN-1000X ACCESSORIES	6
IMPORTANT SAFEGUARDS.....	7
HAVING TROUBLE W/ YOUR SOUND SYSTEM?	8
AN-1000X TECHNICAL SPECIFICATIONS	8

A MESSAGE FROM THE OWNER

Thank you for choosing an Anchor Audio portable sound system. Our products incorporate state-of-the-art design and the finest quality of materials and workmanship. We're proud of our products and appreciate the confidence which you have shown by selecting an Anchor product.

I hope you'll take a few minutes to review this manual. We've incorporated several unique features into our products, and your knowledge of how to use them will enhance the performance and your enjoyment of the system.

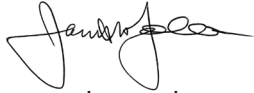

Janet Jacobs - President
on behalf of all Anchor Employees

GETTING STARTED

Please check your new unit carefully for any damage which may have occurred during shipment. Each Anchor product is carefully inspected at the factory and packed in specially designed boxes for safe transport.

Notify the freight carrier immediately of any damage to the shipping box or product. Repack the unit in the original box and wait for inspection by the carrier's claim agent. Notify your dealer of the pending freight claim.

NOTE: All damage claims must be made with freight carrier!

RETURNING SYSTEMS FOR SERVICE OR REPAIR

For service or repair, please contact the dealer you purchased your system from or Anchor Audio Customer Service at (888) 444-6077 to obtain a RA (*Return Authorization*) number. All shipments to Anchor Audio must include an RA number and must be shipped prepaid. C.O.D. shipments will be refused and returned at your expense.

IMPORTANT: Save the shipping box & packing materials, they were specially designed to ship your unit!

WARRANTY REGISTRATION

Please go to our website (www.anchoraudio.com) and select "WARRANTY". Completing this online registration form will activate your limited six-year warranty.

Waste electrical and electronic products must not be disposed of with household waste. Please recycle where facilities exist. Check with your Local Authority or Retailer for recycling advice.



IMPORTANT SAFEGUARDS



CAUTION: To reduce the risk of electric shock, do not remove the cover. No user-serviceable parts inside. Refer servicing to qualified personnel.

WARNING: To prevent fire or electric shock, do not expose this equipment to rain or moisture.



ATTENTION: Pour éviter les risques de choc électrique, ne pas enlever le couvercle. Aucun entretien de pièces intérieures par l'utilisateur. Confier l'entretien au personnel qualifié.

AVIS: Pour éviter les risques d'incendie ou d'électrocution, n'exposez pas cet article à la pluie ou à l'humidité.

EXPLANATION OF GRAPHICAL SYMBOLS



The lightning flash with arrowhead symbol, within an equilateral triangle, is intended to alert the user to the presence of uninsulated "dangerous voltage" within the product's enclosure that may be of sufficient magnitude to constitute a risk of electric shock to humans.



The exclamation point, within an equilateral triangle, is intended to alert the user to the presence of important operating and maintenance (*servicing*) instructions in the literature accompanying the appliance.

EXPLICATION DES SYMBOLES GRAPHIQUES



Le symbole éclair avec point de flèche à l'intérieur d'un triangle équilatéral est utilisé pour alerter l'utilisateur de la présence à l'intérieur du coffret de "voltage dangereux" non isolé d'ampleur suffisante pour constituer un risque d'électrocution.



Le point d'exclamation à l'intérieur d'un triangle équilatéral est employé pour alerter les utilisateurs de la présence d'instructions importantes pour la fonctionnement et l'entretien (*service*) dans le livret d'instruction accompagnant l'appareil.

AN-1000X ACCESSORIES

MIC-90 - Handheld Microphone

Anchor's dynamic, balanced, low impedance microphone with a unidirectional pick-up pattern. It has an on/off switch and comes w/ a 20' cable & mic clip.

AN-1001X - Companion Speaker

Unpowered speaker for use with the AN-1000X. It has a 1/4"-phone input jack and parallel input/output wire terminals. Designed to accept Omnimount® 25-series mounts. Speaker cable not included.

SS-250 - Speaker Stand

Collapsible speaker stand. Rated load capacity 25 pounds. *(Requires SB-1 bracket sold separately)*

SB-1 - Stand Mounting Bracket

U-shaped swivel bracket. Mounts to a wall, ceiling or on a speaker stand. *(Adapter included)*

RM-1 - Single Rackmount Kit

Mounts one AN-1000X in a standard equipment rack.

RM-12 - Dual Rackmount Kit

Mounts two AN-1000X's in a standard equipment rack.

SC-50 - Speaker Cable

Heavy duty speaker cable - 50'.

MSB-201 - Combo Mic/Speaker Stand

Floor stand w/ 33" adjustable boom. Speaker stand when combined w/ SB-1 mounting bracket.

HS-1 - Carry Handle

Convenient attachable handle for AN-1000X.

HC-1550 - Hard Case

Traveling hard case, holds up to two AN-1000X's, two mics & accessories.

FEEDBACK

Feedback is a howling noise or shrill sound that is self-generated by the sound system. It is caused by a microphone picking up the sound coming from the speaker and then being re-amplified. Once a feedback loop is started it will continue until the system is adjusted.

FEEDBACK CAUSES

- Microphone too close, pointing towards or in front of the speaker
- Volume setting too loud for room
- Sound reflections from hard surfaces, walls, etc.

AVOIDING & ELIMINATING FEEDBACK

- Point the microphone in a different direction
- Keep the microphone away from the speaker; position speaker in FRONT of microphone
- Reduce the sound system volume levels

CAUTION: Feedback can damage your equipment & may be hazardous to hearing.

PROBLEMS? Consult the troubleshooting section on the back page of this manual or call Anchor Audio Customer Service - 888-444-6077.

BASIC SYSTEM OPERATION

The AN-1000X is the most versatile powered monitor on the market, is designed to amplify the signal from a wide variety of input sources. Use it on an A/V rack, as a studio monitor, in a trade show booth or on a US Navy warship, you decide.

Here's How Easy It Is To Use

1. Place the AN-1000X in desired location
2. Plug the power cord into a grounded AC outlet
3. Plug an audio source into one of the three input jacks on the back panel:
 - LINE IN - RCA jack
 - LINE IN - 1/4-inch phone jack
 - BALANCED INPUT* - XLR jack
4. Turn volume control on front panel to minimum
5. Set power switch on back panel to ON (red LED on front panel should light)
5. Adjust the volume, bass & treble controls to desired levels

IMPORTANT: To avoid feedback, do not position a microphone in front of speaker.

*BALANCED INPUT JACK

The balanced XLR input jack allows the AN-1000X to be used in a variety of applications. The input can be user configured for a Lo-Z microphone or bridging balanced line-level inputs (such as used in the pro-audio and broadcast industry). In addition, the input has 15 volt phantom power which may be switched on or off.

The factory default setting is for microphone-level inputs w/ 15 volts DC phantom power. Follow the instructions below to change settings.

Change Balanced Input Jack Configuration

1. Set the three dip switches w/ a small pointed object

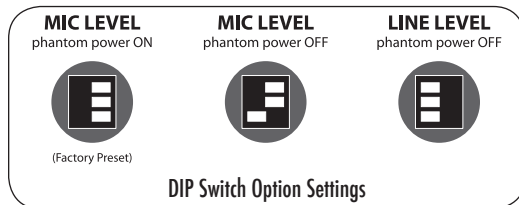

SPEAKER OUT

The external speaker output jack (1/4"-phone, unswitched) allows the user to power an auxiliary un-powered speaker (such as the AN-1001X). Minimum 8 ohms impedance for auxiliary speakers.

LINE OUT

The line-level output provides a replica of the composite input signal. Use it for direct recording or to daisy-chain additional powered sound systems to the AN-1000X for greater crowd coverage.

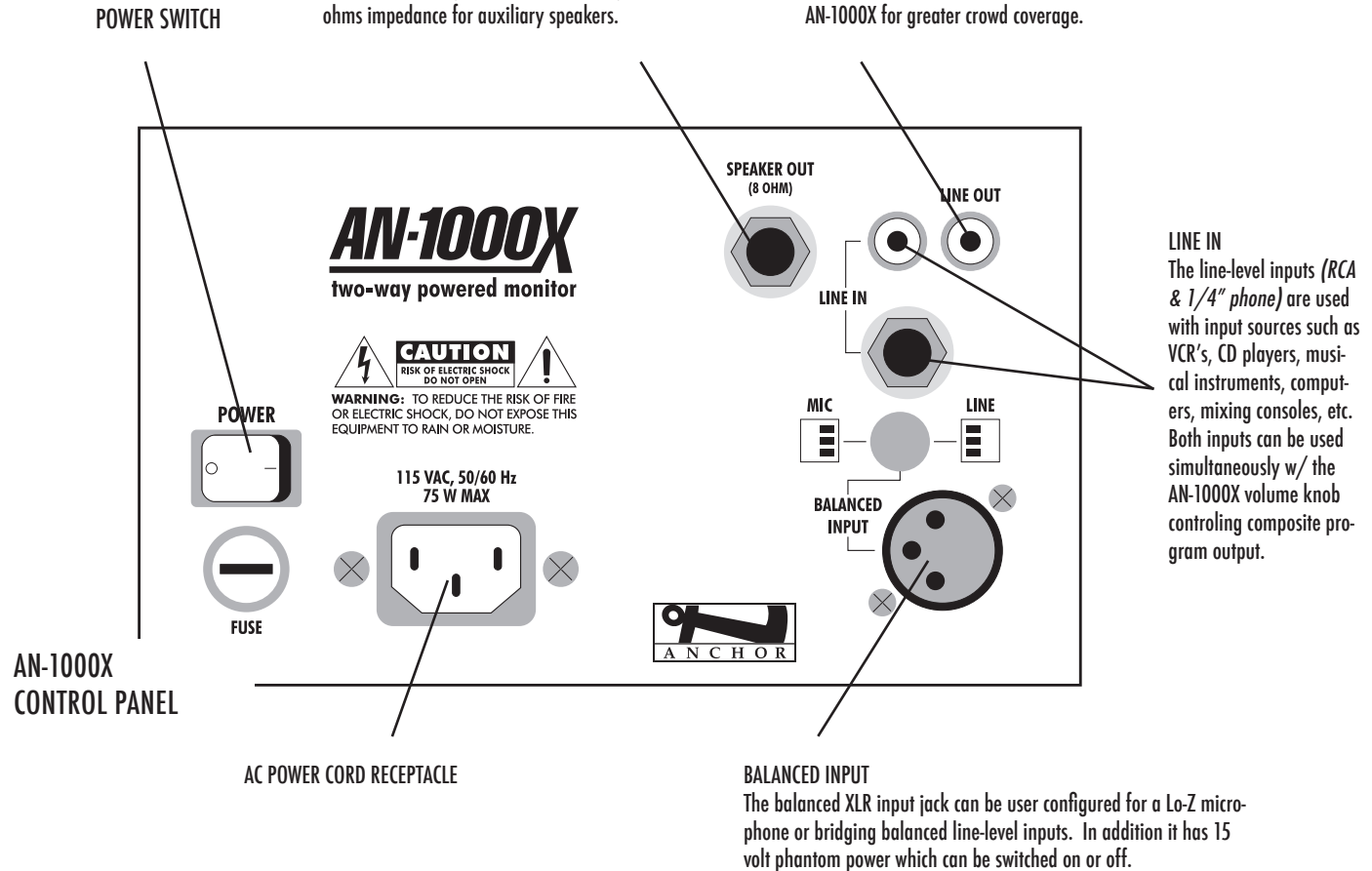

CAUTION: ALWAYS use shielded audio cables on input connections to prevent interference.

PROBLEMS? Consult the troubleshooting section on the back page of this manual.

NEED MORE HELP? Contact the Anchor Audio Customer Service Department - 888-444-6077.